

#### Acoustic doors for Acustimodul-80

##### PRESENTATION

The range of acoustic doors **RS5C** designed and manufactured by **Acústica Integral**, meet the market demands. They certified doors, of high performance, quality, robustness.

##### ADVANTAGES

Acoustic door with special frame design to fit into the modular system **Acustimodul-80**.

Dimensions proportionate to the standard width of the module. Insulation and aesthetics in line with **Acustimodul-80**.

Own automated manufacture. Standard models and special measures.

##### APPLICATIONS

Enclosures, cabins and acoustic barriers made with **Acustimodul-80**.

##### SPECIAL ACCESSORIES (upon order)

Circular or rectangular vision panel, visible key-lock, push-bar.

##### TECHNICAL DATA

**Description:** 69mm thick acoustic door composed by frame and 1.5mm thick metal plate, filled with soundproofed and absorbing material. Equipped with double perimeter seals.

**Closure:** Outdoor pressure.

**Surface finishing:** Synthetic primer (prepared for painting). Color paint RAL on request.

**Heat transfer:** 1.93 W/m<sup>2</sup>K.

**Acoustic certification:** APPLUS N° 08/32311060 valid for the door without accessories.



##### STANDARD DIMENSION

###### One leaf (width x height mm.)

Model	Int. Dim.	Ext. Dim.	Opening Panel
RS5C/01	825x1910	965x2050	865x1950
RS5C/02	1275x1910	1415x2050	1315x1950

###### Two leaf (width x height mm.)

Model	Dim. Int.	Dim. Ext.	Opening Panel
RS5C/21	1275x1910	1415x2050	1315x1950
RS5C/22	1725x1910	1865x2050	1765x1950
RS5C/23	2175x1910	2315x2050	2215x1950

Unequal leaves (848+427) for RS5C/21

##### HANDLE DETAIL

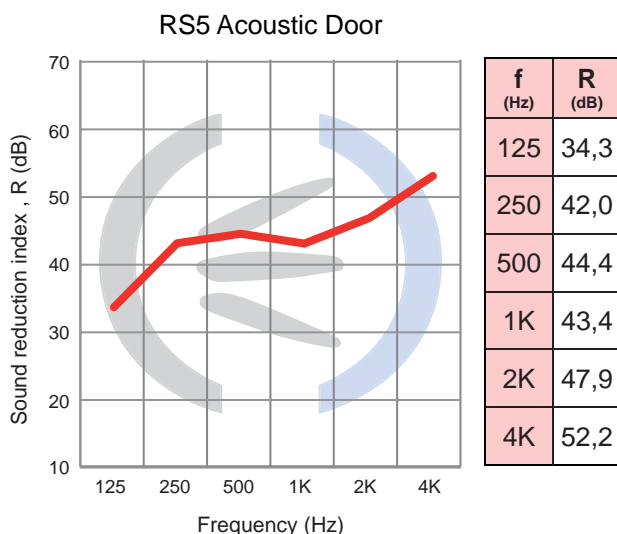

RS5C	
Overall sound reduction index, $R_w$ (C;Ctr):	46 (0;-3) dB
Overall weighted sound reduction index A, $R_A$ :	45,6 dBA

### ASSEMBLY INSTRUCTIONS

The **RS5C** door must be placed with the door closed, do not open until assuring the level and that it is well fixed. We will position the door in the place chosen, resting it and inserting it into the panel frame. We will continue placing panels. On the top part of the door place the panels cut at the right measure of the closure or barrier. Once the door is levelled, fix with screws to the panels.

#### Handling:

- Equipped with snap-fit closing: To open it hold the lever strongly and turn it clockwise and push the door; to close it hold the lever strongly, bring the door to the frame and only then turn the lever counter clockwise until the end.

- Equipped with panic bars: To open press the bar downwards and push the door; to close hold the bar or handle and bring towards the frame.

**Use restrictions:** Do not bang the door with anything that may deform it. Once the door is open do not hang from it. Close the door gently without banging it.

**Preventive maintenance:** We recommend an annual revision, for this purpose **Acústica Integral** provides a standard contract in which we will check: Mobile elements of the doors ( Hinges, levers and locks): cleaning, greasing and adjustment and verification of the good operation of all the parts. Seals or intumescent joints: replacement of damaged or malfunctioning elements..Verification of gaps.



### SKETCH / PLANS

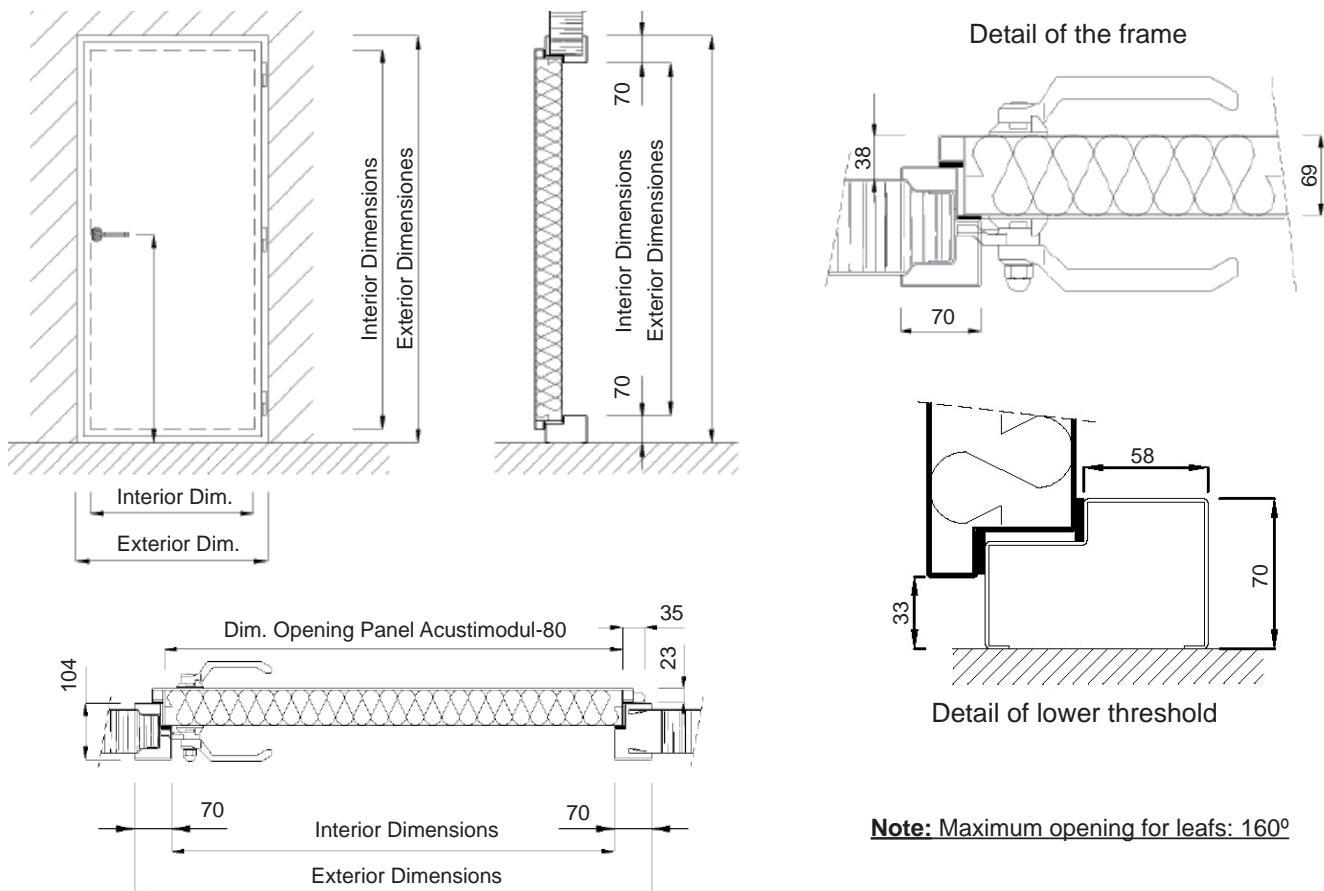

**Note:** Maximum opening for leafs: 160°